

LMR32

單軸
1-axis

軸棒線馬

Linear shaft motor



最大行程 Maximum Stroke	1940mm	最高速度 Maximum Speed	2500mm/s	連續推力 Continuous thrust	187N
連續可搬重量 Continuous Payload	51kg	磁棒外徑 Maximum Stroke	φ32mm	直線滑軌 Linear Guide	42mmX9.5mm- 1 pcs

型號表示方式 Ordering Method

LMR32 - 06 - RH - N - 1940 - LS - R - 05 - T2 71L - A001

本體型號
Model

特注式樣
Customization Order No.

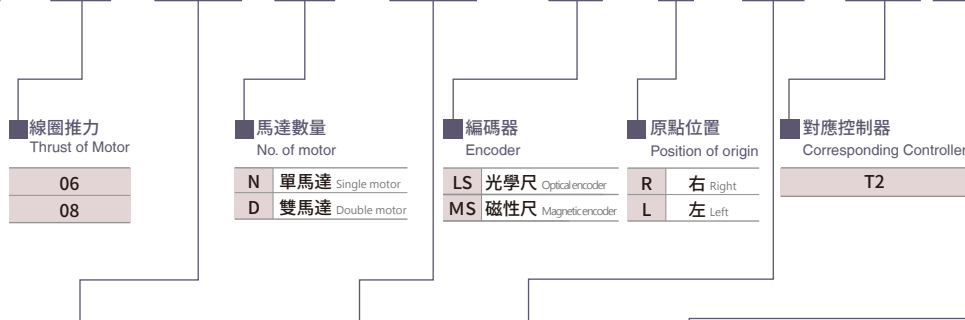

本體固定方式 Main body fixed method	RH 本體水平固定 Horizontally fixed	LW 本體壁掛固定 Wall mounting
---	------------------------------	-------------------------

行程 Stroke	75 75mm	1940 1940mm
※60mm間距。 ※ Pitch: 60mm.		

線長 Cable Length	05 5m	08 8m	12 12m
標配5m。 Standard:5m.			

容量 Capacity	7 750W	電壓 Voltage	1 單相220V Single-phase 220V	3 三相220V Three phase 220V
--------------------	--------	-------------------	----------------------------	---------------------------

功能 Function	L 標準型 Standard type(pulse)	F DMCNET	U 電子凸輪 ECAM	M CANopen
--------------------	----------------------------	----------	-------------	-----------

免費服務專線：大陸 400-875-0009 台灣 0800-800-893
Toll-Free Number China Taiwan

加速度-連續可搬重量 Acceleration-Continuous Payload

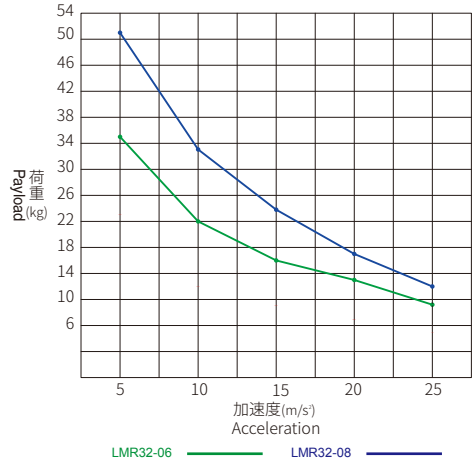

規格 Spec	型號 Model		LMR32-06	LM32-08
	位置重複精度 Repeatability (mm)		±0.002mm	
	最大推力 Max. thrust (N)		561	748
	連續推力 Continuous thrust (N)		140	187
	連續可搬重量 Continuous Payload (kg)		35	51
	標準行程 Stroke / Pitch (mm)	單馬達 N	140-1940mm / 60間隔	140-1880mm / 60間隔
雙馬達 D		75-1695mm / 60間隔	80-1580mm / 60間隔	
最高速度 Maximum Speed (mm/s) ※1		2500mm/s		
部品 Parts	定子外徑 Outer dia. Of stator		φ 32	
	光學尺廠牌 Brand of linear scale		RENISHAW	
	讀頭 Reader		RH200X05A00A	
	Z相原點 Origin of Z phase		A-9541-0037	
	光學尺解析度 Resolution of linear scale		0.001mm	

※1 連續可搬重量為到連線速度1m/s,最大加速度5m/s²固定行程來回,不同情況會有不同。
The continuous payload is the data when the robot runs with maximum speed 1m/s and acceleration 5m/s². Different application will have different result.

容許負載力距表 Allowable Moment

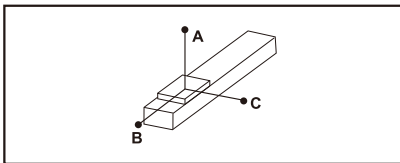

(單位 Unit:mm)

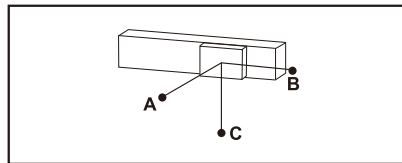

(單位 Unit:mm)

靜態容許負載慣量 Static Loading moment

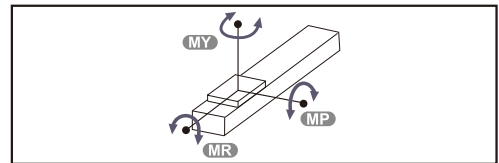

(單位 Unit:N.m)

水平安裝 Horizontal Installation ※2					
速度 Speed (m/s)	荷重 Load (kg)	容許負載力距 (Unit:mm)			
		A	B	C	
LMR 32 - 08 - RH	1	35	315	84	48
	1	17	720	203	116
	1.5	22	216	99	54
	1.5	11	480	230	125
	2	14.3	180	126	61
	2	7	400	294	140
	2.5	10	200	195	83
	2.5	5	425	425	180
LMR 32 - 06 - RH	1	51	272	64	27
	1	25	660	180	77
	1.5	29	218	95	38
	1.5	15	480	225	92
	2	19	180	122	46
	2	10	380	275	102
	2.5	13	208	200	68
	2.5	6	495	490	165

壁掛安裝 Wall Installation ※2					
速度 Speed (m/s)	荷重 Load (kg)	容許負載力距 (Unit:mm)			
		A	B	C	
LMR 32 - 08 - LW	1	38	43	72	285
	1	19	105	178	640
	1.5	22	54	99	205
	1.5	11	125	230	480
	2	14.1	62	129	182
	2	7	140	294	400
	2.5	10	83	195	200
	2.5	5	180	425	425
LMR 32 - 06 - LW	1	51	27	55	230
	1	25	76	154	570
	1.5	29	38	81	185
	1.5	15	90	195	410
	2	19	44	105	152
	2	10	99	235	325
	2.5	13	65	173	178
	2.5	6.5	145	385	385

LMR 32 - 06	MY	173
	MP	173
	MR	111
LMR 32 - 08	MY	209
	MP	209
	MR	111

※2 相同速度下加速度時間不同, 加速度也隨之變化, 荷重也隨之改變, 表為加速度時間0.2s。
Even the speed is same, if acceleration and acceleration time is changed, the payload will be different. Above chart is based on acceleration time 0.2 sec.

對應控制器一覽表 Corresponding Controller Chart

外觀 Exterior	控制器型號 Controller Model	選配介面 Control Mode	電氣規格 Electrical Spec.	詳細參閱 Reference Page
	T2	標準型 Pulse Control Mode	單相或三相220V Single-phase 220V or Three phase 220V	P.33
		DMCNET		
		電子凸輪 ECAM		
		CANopen		

LMR32

單軸
1-axis

軸棒線馬

Linear shaft motor

LMR32-06-RH-N



• CAD圖面可至www.toyorobot.com下載
Please download the CAD file from TOYO's website: www.toyorobot.com

單位 Unit : mm

履帶截面圖
Sectional view of connecting track

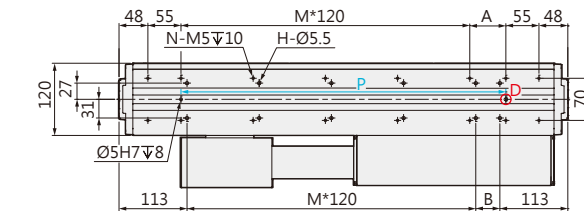
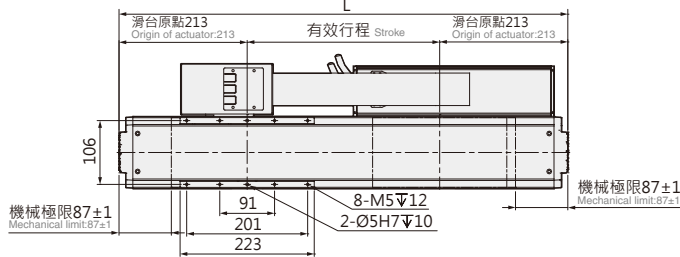
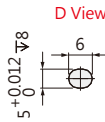
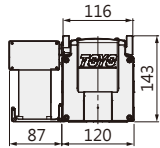
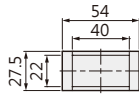

有效行程 stroke	140	200	260	320	380	440	500	560	620	680	740	800	860	920	980	1040	1100	1160	1220	1280	1340	1400	1460	1520	1580	1640	1700	1760	1820	1880	1940
L	566	626	686	746	806	866	926	986	1046	1106	1166	1226	1286	1346	1406	1466	1526	1586	1646	1706	1766	1826	1886	1946	2006	2066	2126	2186	2246	2306	2366
A	120	60	120	60	120	60	120	60	120	60	120	60	120	60	120	60	120	60	120	60	120	60	120	60	120	60	120	60	120	60	120
B	100	40	100	40	100	40	100	40	100	40	100	40	100	40	100	40	100	40	100	40	100	40	100	40	100	40	100	40	100	40	100
P	360	420	480	540	600	660	720	780	840	900	960	1020	1080	1140	1200	1260	1320	1380	1440	1500	1560	1620	1680	1740	1800	1860	1920	1980	2040	2100	2160
M	2	3	3	4	4	5	5	6	6	7	7	8	8	9	9	10	10	11	11	12	12	13	13	14	14	15	15	16	16	17	17
N	12	14	14	16	16	18	18	20	20	22	22	24	24	26	26	28	28	30	30	32	32	34	34	36	36	38	38	40	40	42	42
H	8	10	10	12	12	14	14	16	16	18	18	20	20	22	22	24	24	26	26	28	28	30	30	32	32	34	34	36	36	38	38
KG	14.3	15.5	16.8	18	19.2	20.5	21.7	22.9	24.1	25.4	26.6	27.4	28.7	29.9	31.2	32.4	33.7	35.2	36.4	37.7	38.9	40.1	41.4	42.6	43.8	45	46.3	47.5	48.7	50	51.2

LMR32-06-RH-D



• CAD圖面可至www.toyorobot.com下載
Please download the CAD file from TOYO's website: www.toyorobot.com

單位 Unit : mm

履帶截面圖
Sectional view of connecting track

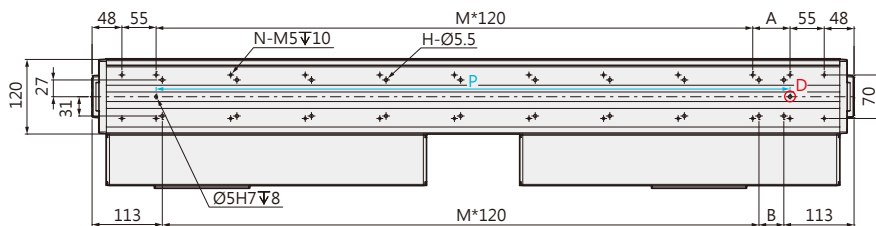
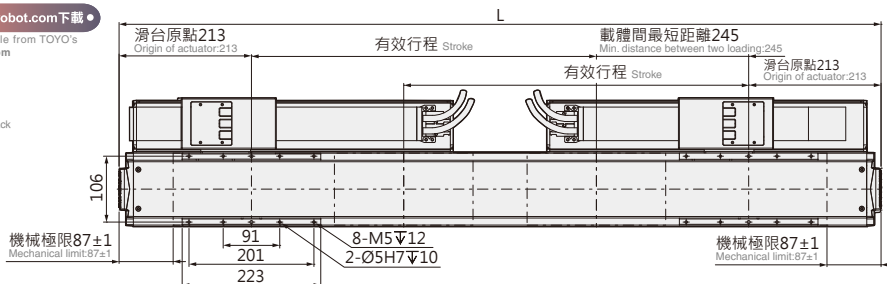
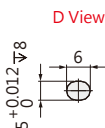
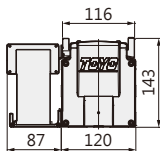
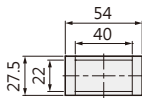

有效行程 stroke	75	135	195	255	315	375	435	495	555	615	675	735	795	855	915	975	1035	1095	1155	1215	1275	1335	1395	1455	1515	1575	1635	1695
L	746	806	866	926	986	1046	1106	1166	1226	1286	1346	1406	1466	1526	1586	1646	1706	1766	1826	1886	1946	2006	2066	2126	2186	2246	2306	2366
A	60	120	60	120	60	120	60	120	60	120	60	120	60	120	60	120	60	120	60	120	60	120	60	120	60	120	60	120
B	40	100	40	100	40	100	40	100	40	100	40	100	40	100	40	100	40	100	40	100	40	100	40	100	40	100	40	100
P	540	600	660	720	780	840	900	960	1020	1080	1140	1200	1260	1320	1380	1440	1500	1560	1620	1680	1740	1800	1860	1920	1980	2040	2100	2160
M	4	4	5	5	6	6	7	7	8	8	9	9	10	10	11	11	12	12	13	13	14	14	15	15	16	16	17	17
N	16	16	18	18	20	20	22	22	24	24	26	26	28	28	30	30	32	32	34	34	36	36	38	38	40	40	42	42
H	12	12	14	14	16	16	18	18	20	20	22	22	24	24	26	26	28	28	30	30	32	32	34	34	36	36	38	38
KG	24.5	25.7	27	28.1	29.4	30.6	31.8	33.1	33.9	35.15	36.4	37.7	38.9	40.2	41.7	42.9	44.1	45.4	46.6	47.8	49	50.3	51.5	52.7	54	55.2	56.4	57.7

免費服務專線：大陸 400-875-0009 台灣 0800-800-893
Toll-Free Number China Taiwan

LMR32-06-LW-N

CAD圖面可至www.toyorobot.com下載
Please download the CAD file from TOYO's website: www.toyorobot.com

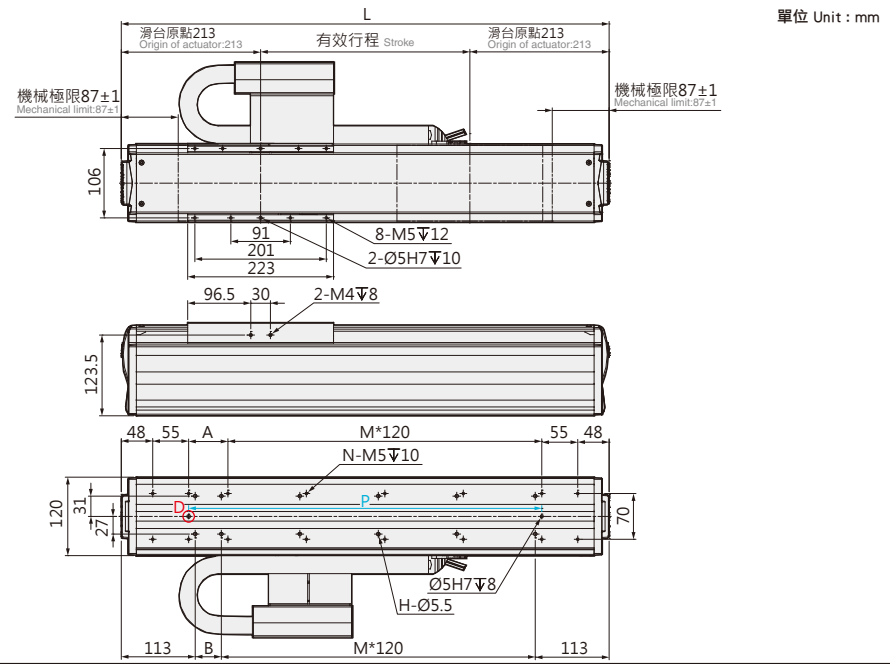
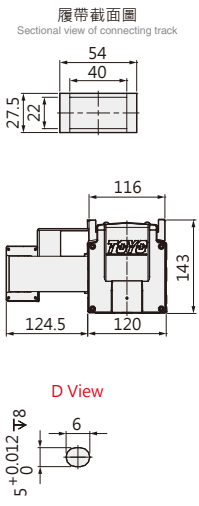

有效行程 stroke	140	200	260	320	380	440	500	560	620	680	740	800	860	920	980	1040	1100	1160	1220	1280	1340	1400	1460	1520	1580	1640	1700	1760	1820	1880	1940
L	566	626	686	746	806	866	926	986	1046	1106	1166	1226	1286	1346	1406	1466	1526	1586	1646	1706	1766	1826	1886	1946	2006	2066	2126	2186	2246	2306	2366
A	120	60	120	60	120	60	120	60	120	60	120	60	120	60	120	60	120	60	120	60	120	60	120	60	120	60	120	60	120	60	120
B	100	40	100	40	100	40	100	40	100	40	100	40	100	40	100	40	100	40	100	40	100	40	100	40	100	40	100	40	100	40	100
P	360	420	480	540	600	660	720	780	840	900	960	1020	1080	1140	1200	1260	1320	1380	1440	1500	1560	1620	1680	1740	1800	1860	1920	1980	2040	2100	2160
M	2	3	3	4	4	5	5	6	6	7	7	8	8	9	9	10	10	11	11	12	12	13	13	14	14	15	15	16	16	17	17
N	12	14	14	16	16	18	18	20	20	22	22	24	24	26	26	28	28	30	30	32	32	34	34	36	36	38	38	40	40	42	42
H	8	10	10	12	12	14	14	16	16	18	18	20	20	22	22	24	24	26	26	28	28	30	30	32	32	34	34	36	36	38	38
KG	14.6	15.7	16.9	18	19.2	20.3	21.5	22.6	23.8	24.9	26	27.2	28.4	29.5	30.7	31.8	33	34.1	35.3	36.4	37.6	38.7	39.9	41	42.1	43.3	44.5	45.6	46.8	47.9	49.1

LMR32-06-LW-D

CAD圖面可至www.toyorobot.com下載
Please download the CAD file from TOYO's website: www.toyorobot.com

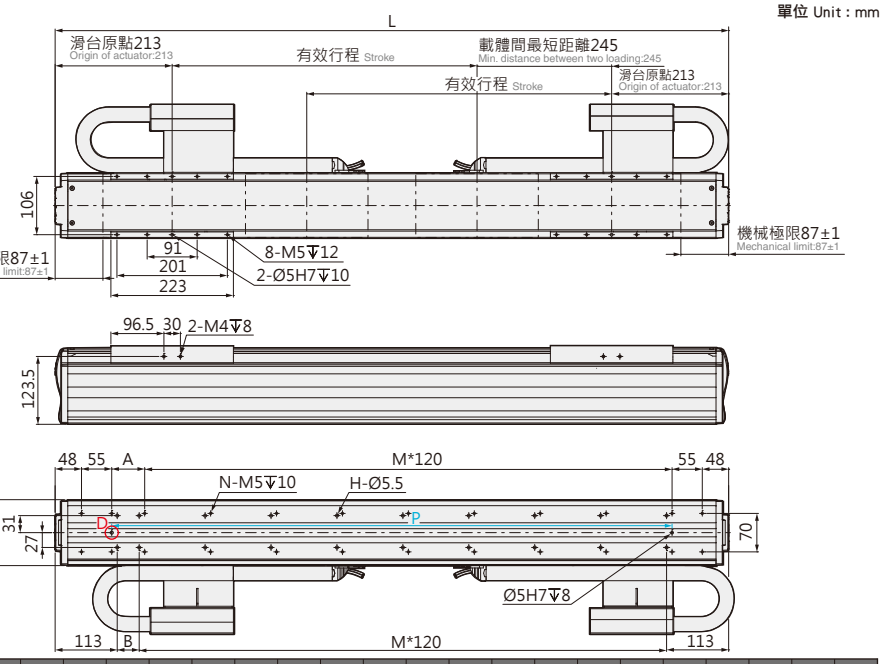
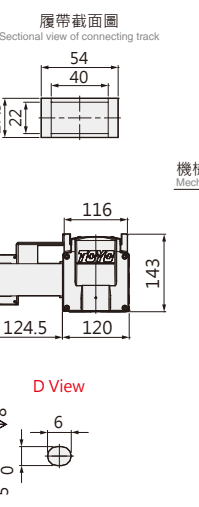

有效行程 stroke	75	135	195	255	315	375	435	495	555	615	675	735	795	855	915	975	1035	1095	1155	1215	1275	1335	1395	1455	1515	1575	1635	1695
L	746	806	866	926	986	1046	1106	1166	1226	1286	1346	1406	1466	1526	1586	1646	1706	1766	1826	1886	1946	2006	2066	2126	2186	2246	2306	2366
A	60	120	60	120	60	120	60	120	60	120	60	120	60	120	60	120	60	120	60	120	60	120	60	120	60	120	60	120
B	40	100	40	100	40	100	40	100	40	100	40	100	40	100	40	100	40	100	40	100	40	100	40	100	40	100	40	100
P	540	600	660	720	780	840	900	960	1020	1080	1140	1200	1260	1320	1380	1440	1500	1560	1620	1680	1740	1800	1860	1920	1980	2040	2100	2160
M	4	4	5	5	6	6	7	7	8	8	9	9	10	10	11	11	12	12	13	13	14	14	15	15	16	16	17	17
N	16	16	18	18	20	20	22	22	24	24	26	26	28	28	30	30	32	32	34	34	36	36	38	38	40	40	42	42
H	12	12	14	14	16	16	18	18	20	20	22	22	24	24	26	26	28	28	30	30	32	32	34	34	36	36	38	38
KG	24.4	25.5	26.6	27.8	28.9	30.1	31.2	32.3	33.5	34.6	35.8	36.9	38	39.2	40.3	41.5	42.6	43.7	44.9	46	47.2	48.3	49.4	50.6	51.7	52.9	54	55.1